

Proj. No.: 5908-002 State: GA County: HENRY Station: HC07-16

Year Established: 2007 Agency/Client: HENRY COUNTY

Type of Survey: GPS Accuracy Classification: THIRD Order, Class I

\*\*\*\*\*

Sketch:

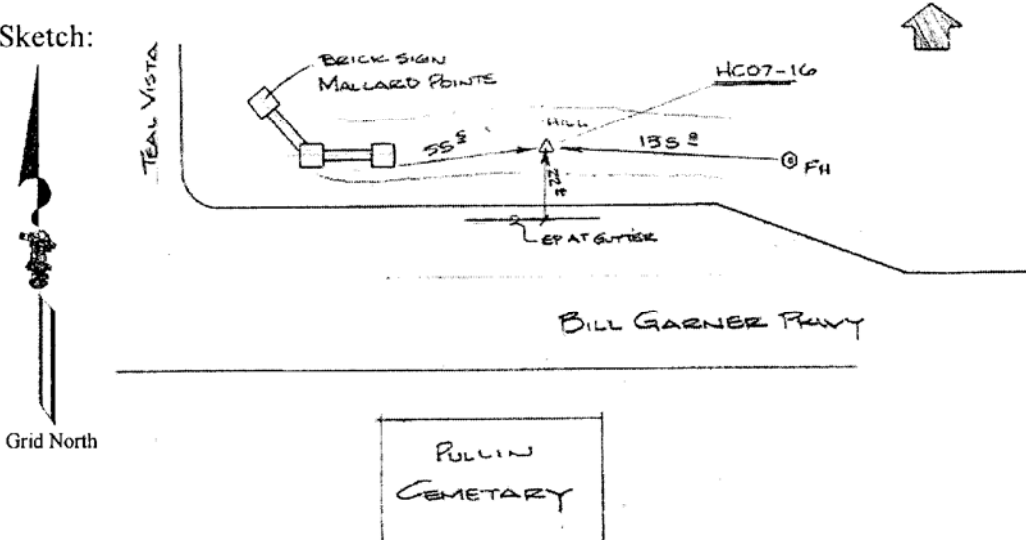

\*\*\*\*\*

Description STATION IS E OF THE INTRSX OF TEAL VISTA AND BILL GARDNER PKWY. IN THE  
N.R.O.W. OF BILL GARDNER PKWY.. REFERENCE MARK 1, 22.6 FEET FROM THE EP AT GUTTER.  
REFERENCE MARK 2, 55.5 FEET FROM THE SE CORNER OF A BRICK SIGN. REFERENCE MARK 3,  
135.8 FEET FROM A FIRE HYDRANT. STATION IS A 2 IN. ALUM. DISK STAMPED "HC07-16".

GEODETIC POSITION

Latitude: 33° 21' 37.810071" N Longitude: 84° 10' 20.560007" W  
 WGS84 ( ) CLARK1866 ( )  
 GRS80 (X)  
 Orthometric Height: 254.312 M. 834.354 Ft. Geoid Hgt.: -28.729 M.  
 1988 NAVD (X) Geoid  
 1929 NGVD ( ) Model 03

STATE PLANE POSITION

State: GA Zone: WEST Zone #: 1002 Projection: TM  
 NAD83 (X) Adj. (COR96) 1927NAD ( )

N: 1222372.632 US Ft (X) E: 2294839.611 US Ft. (X)  
 Int Ft. ( ) Int Ft. ( )  
 N: 372579.923 M. E: 699468.512 M.

Combined Scale Factor: 0.99986459 Convergence: - 0 00 11.306